

Part Names - Main Unit English Guide

- The number shown in each  is the page number where the part's function and/or use are explained in Japanese.

Front view

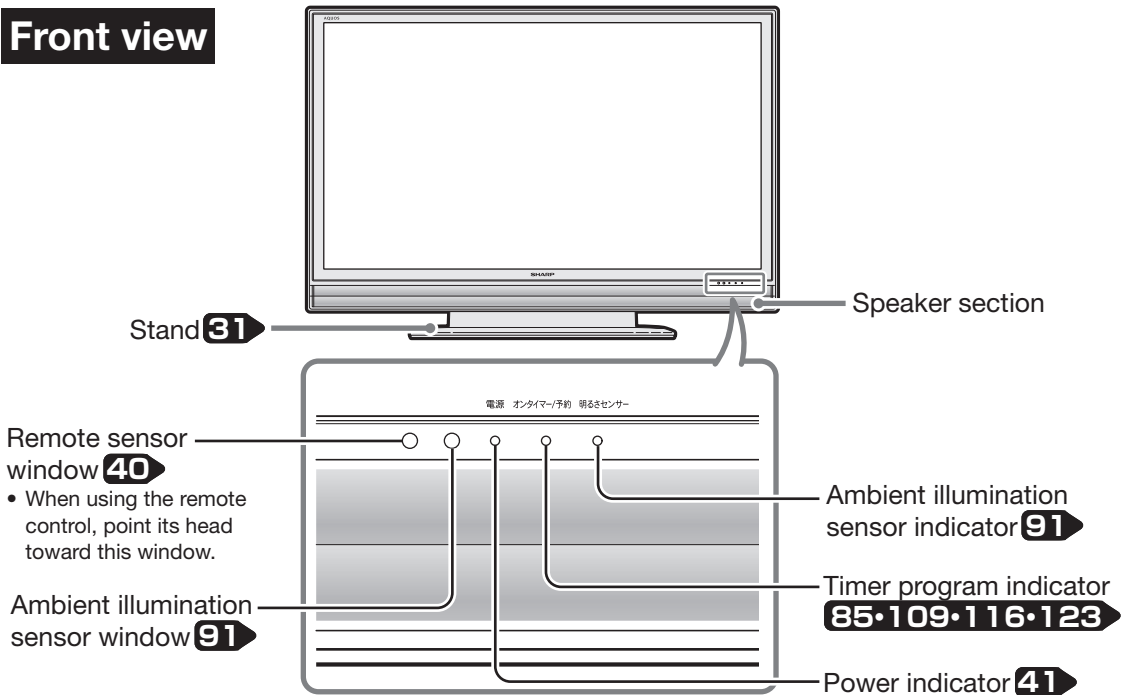

Adjusting the LCD panel angle (LC-37ES50 only) **17**

- The LCD panel can be rotated horizontally up to 10° clockwise and counter-clockwise.
- Hold the stand firmly when you adjust the monitor's angle.

Control panel

Right side view

- Main power switch **41**
 - Menu button **42**
 - Input / TV select (Enter) button **103**
 - Channel up (^) / down (v) buttons
 - Volume up (+) / down (-) buttons
- 電源
- メニュー
- 入力/放送切換 (決定)
- 選局
- 音量

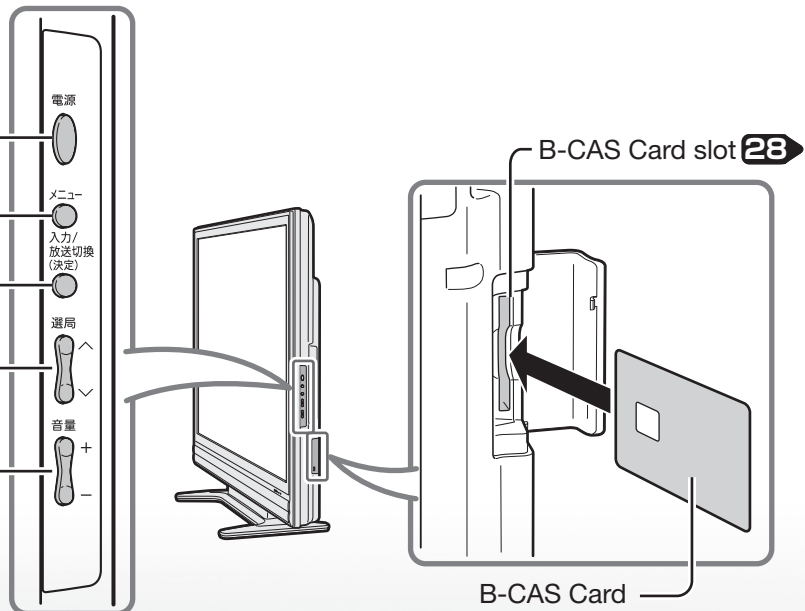

Back view

The illustrations below are those of LC-52ES50.

LC-46ES50/LC-42ES50/LC-37ES50 have almost the same layout of jacks and terminals as LC-52ES50.

LAN jack

(10BASE-T/100BASE-TX)

145

Connect the telephone line

Telephone line jack **145**

Connect a Blu-ray Disc player, AV amplifier, etc.

AV in 1 and 2 (HDMI)

36·101·102·119·128·132

AV in 6

101·112·128·131

AV in 4 **36·101·128**

RS-232C **140**

AV in 7 (PC) **133**

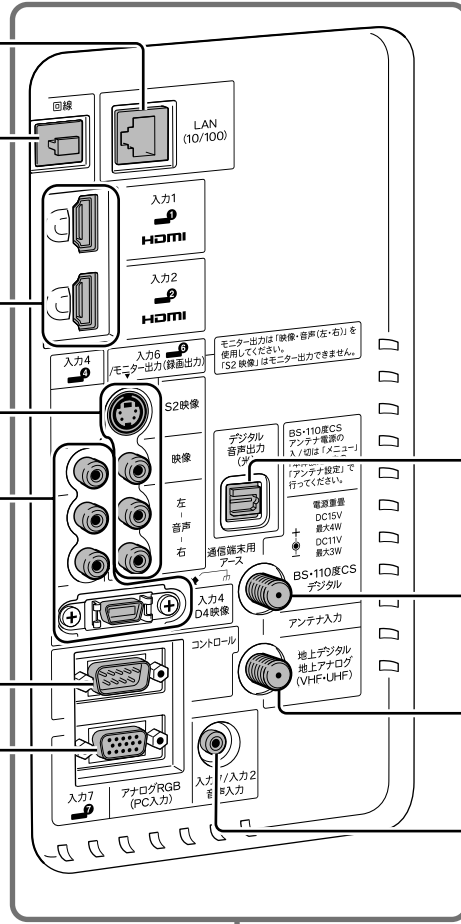

LC-52ES50/
LC-46ES50/
LC-42ES50/
LC-37ES50

Digital audio output jack (optical) **119·130**

BS-CS 110 antenna input terminal **32~35**

VHF-UHF antenna input terminal **32~35**

PC input (audio) **132**

LC-52ES50/LC-46ES50/
LC-42ES50/LC-37ES50

AV in 3 (HDMI)

36·101·102·119·128·132

AV in 5

36·101·128

Connect a video game equipment, video camera, etc.

Headphones jack

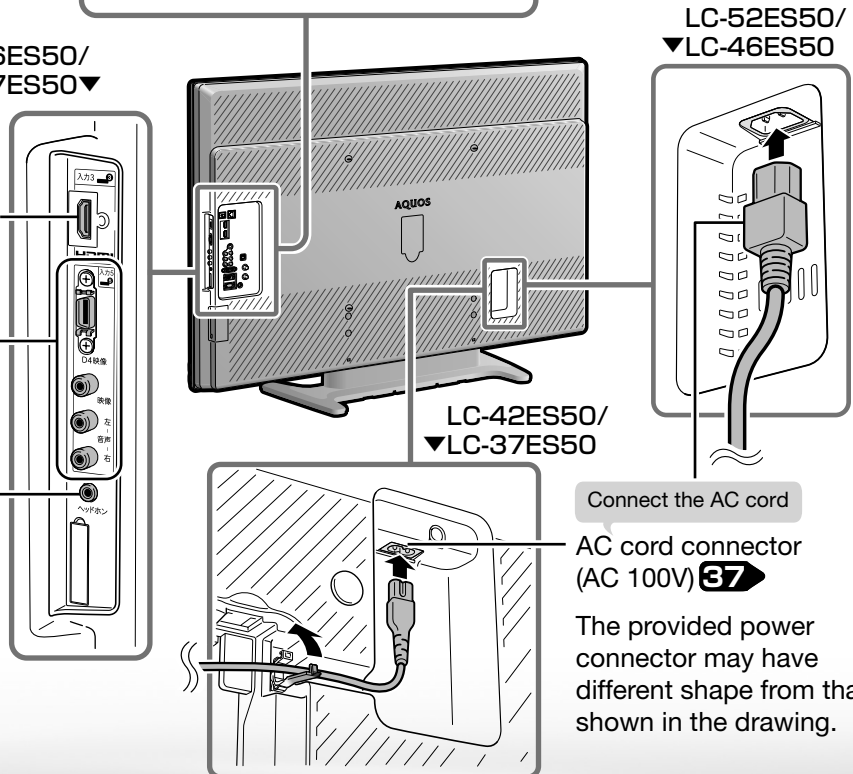

The provided power connector may have different shape from that shown in the drawing.

はじめに

準備

番組を見る

ハイブリッドレコーダー
パソコンなどによる

ファミリーリンク
で録画・再生

本機の機能の活用

故障かな仕様な
寸法図など

English

Guide

Part Names - Remote Control Unit

Active/Standby 41

Press to engage the TV set in the active or standby mode.

CATV 72

When selecting a CATV channel by entering the channel number, press this button first, then enter the 2-digit number with the TV channel select buttons (1-10/0).

Terrestrial digital select 68

BS select 68

CS select 68

Terrestrial analog select 68

Select the CS digital channel for the first time. 47

linked data broadcast 72 · 84

Press to call the data broadcast linked with the current digital TV program.

Volume up (+)/down (-) 69

Press to adjust the volume.

Mute 69

Press to temporarily turn off the sound. Press again to return the sound volume to the previous level.

Program info 76 · 83

Press to display detailed information on the current digital program.

EPG 74 · 76

Press to display or turn off the Electronic Program Guide (EPG: 番組表) when receiving a digital broadcast.

Other on-air programs 75

Press to display the EPG for currently on-air programs only (裏番組).

Finish 42

Press to finish menu operation, etc.

* This button can be conveniently used when you are at a loss during menu or EPG operation, etc.

Screen mode 87

Press to select the desired screen mode.

AV mode select 89

Press to select the picture/sound setting that best matches the current program.

Freeze 82

Press to freeze the picture.

Favorite channel select/register 71

Press to select a user-registered channel and to turn on/off the favorite channel register/registered channel table screen.

Familink 122 · 124~127

Press to operate "Familink" Recorders and AQUOS Surround connected via HDMI cables.

Display 70

Press to display or turn off the channel call, etc.

Sleep timer 160

Press to select the desired remaining time period after which the TV set is automatically turned off and enters the standby mode.

Digital channel number input 71

Use to select a digital channel by entering the 3-digit channel number.

Familink 122 · 125

Press to operate "Familink" Recorders and AQUOS Surround connected via HDMI cables.

Channel select 69

- Press to select a channel.
- Use to input a number for various settings.

Channel up (^)/down (v) 69

Press to select channels in the current network, media and CATV channels in the ascending or descending order.
* CATV channels are factory set to be skipped.

Media select 68 · 72

Press to select the desired media (TV or data).

Input select 103

Press to select the desired input.

Menu 42

Press to display or turn off the menu screen.

The menus can be displayed in English. See 191 for instructions on how to switch the display language.

Cursor (up, down, left, right) 42

Use to select a menu item, column, etc.

Enter/Confirm 42

Press to confirm a selected setting or menu item.

Return 42

Press to go back to the previous screen. Press this button instead of the Enter/Confirm (決定) button when you have selected the wrong item or input the wrong number, etc.

Color 76 · 77

Use to operate EPGs and data program screens.

Picture select 81

Press to select the desired picture when watching a digital multi-picture program.

Caption 81

Press to display, select, or turn off captions when watching a digital program with captions.

Audio select 80 · 81

Press to select the desired audio.



To open the cover

Hold the cover by the projections on both sides and lift upwards.

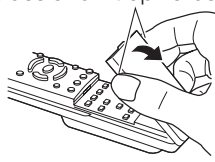

Switching the Display Language to English メニューなどの言語を英語にする

- Using the menu screen, you can switch the on-screen display language to English.

メニューなどの画面表示を英語にすることができます。

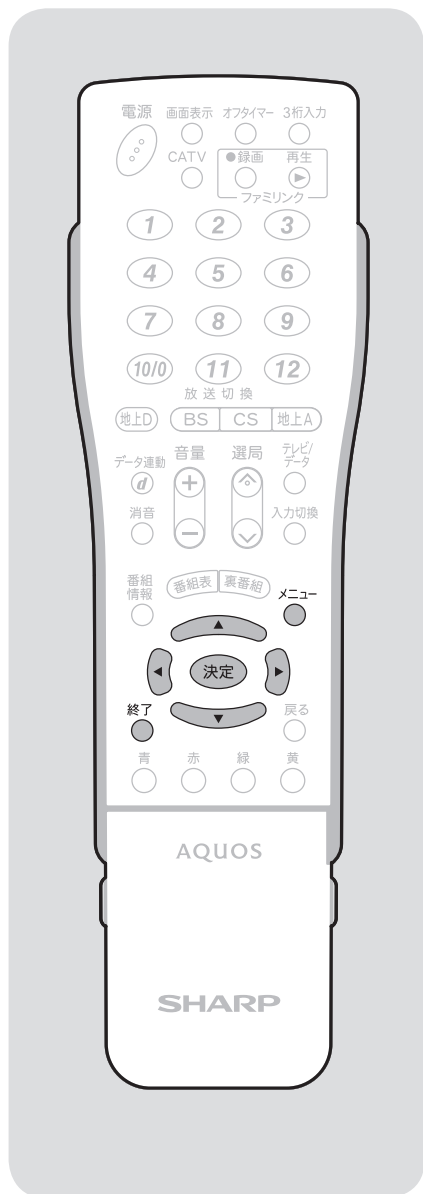

1

Display the menu screen.
メニューを表示する

Press
メニュー

2

Select “本体設定” (Setup) –
“Language (言語設定)” and Enter.

Select with

「本体設定」 – 「Language (言語設定)」
を選ぶ

Press
決定

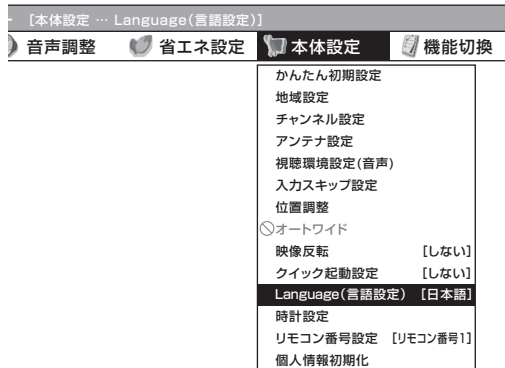

3

Select “English” and Enter.

Select with

「English」を選ぶ

Press
決定

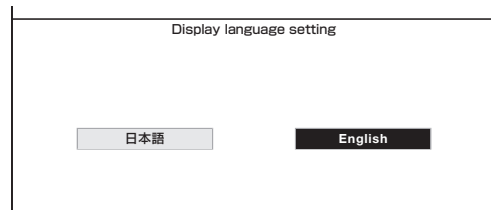

- The menu screen is now displayed in English.
- 画面表示が英語になります。

4

Finish this operation.

Press
終了

終了する



おしらせ

誤ってメニューを英語にしてしまったときは

- メニューから「Setup」 – 「言語設定 (Language)」を選んで決定し、「日本語」を選んで決定すると日本語になります。

はじめに

準備

番組を見る

ハイデュープレヤー！
パソコンなどにもなご

ファミリーリンク
で録画・再生

活用
本機の機能の

寸法図など
故障かな仕様

English
Guide