

Layout

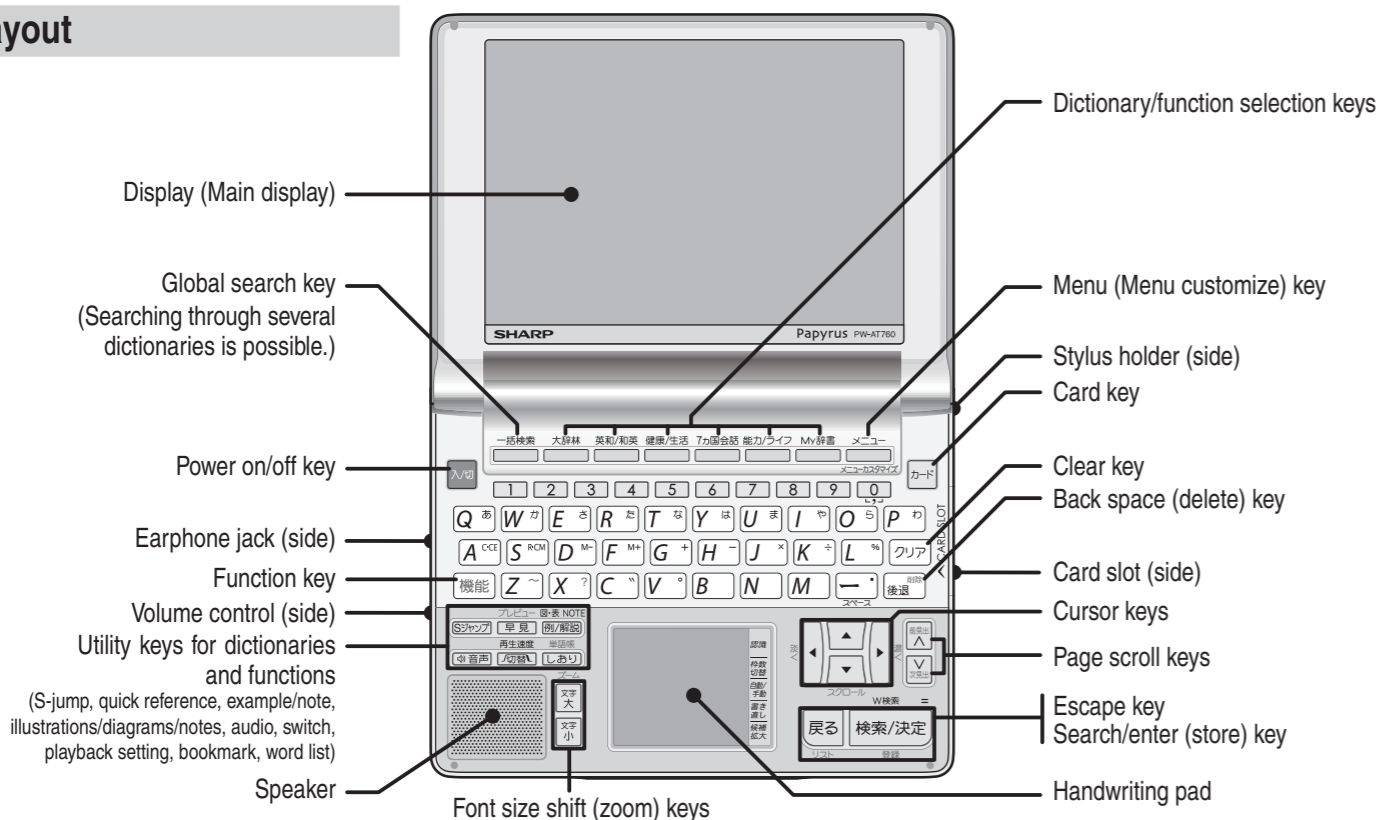

Using the handwriting pad

Parts and functions

The handwriting pad is set to enter characters when the cursor is in any part of the character entry area.

Single-frame pad

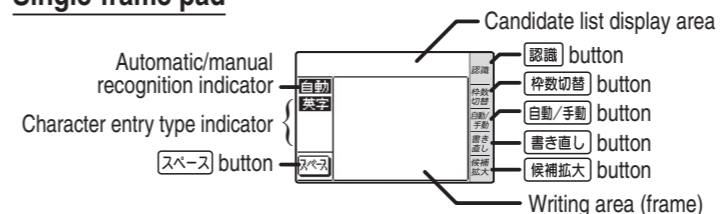

Dual-frame pad

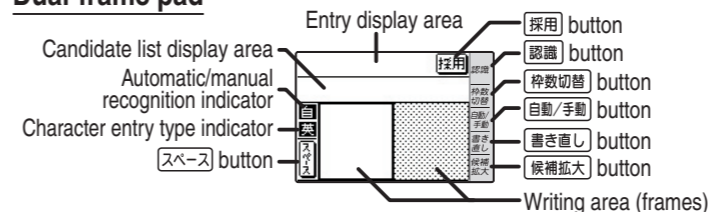

Entering characters using the single-frame pad

Example: Enter a Japanese word “持つ” in the Japanese-English dictionary.

1 Press [メニュー] [0] [2] [1].

The entry/selection screen of ジーニアス英和 & 和英辞典 appears, with the cursor placed over the spelling entry area.

The handwriting pad is set to the English character entry mode.

- If the dual-frame pad is displayed, press [枠数切替] to switch to the single-frame pad.

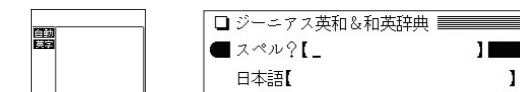

2 Press [▼] to move the cursor to the Japanese entry area. The handwriting pad is now switched to enter kanji and kana.

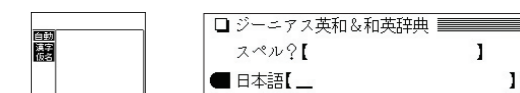

3 Use the stylus to draw “持” on the handwriting pad.

The character shown in the candidate list display area is also placed in the entry area so that the dictionary search can proceed.



4 If the character in the entry area is not the one you desired, use the stylus to touch and select the desired character in the list. The character in the entry area changes.

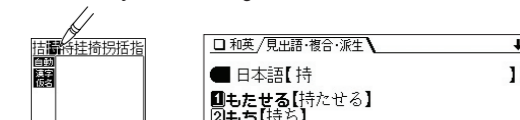

- If you cannot find the character in the list, touch [書き直し] or press [後退] to erase it and reenter it on the pad.

Using the PW-AT760 for the first time

Insert the batteries using the procedure below before using the PW-AT760 for the first time.

To insert the batteries

1 Set the battery replacement switch on the bottom of the unit to the “解除 (交換時)” position.

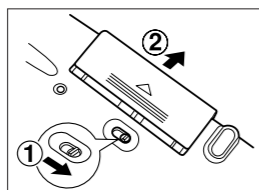

2 Remove the battery cover as shown in the diagram.

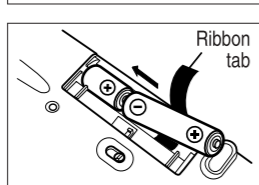

3 Insert the batteries included with the unit.

Make sure the battery polarity is correct.

- Insert the batteries over the ribbon tab being sure not to cover the end of the tab.

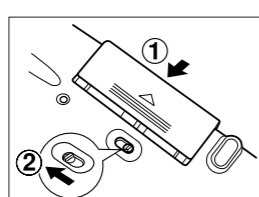

4 Replace the battery cover as shown in the diagram.

5 Set the battery replacement switch to the “ロック (使用時)” position.

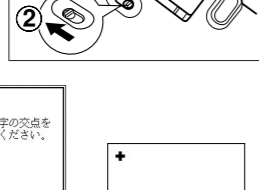

6 Open the unit and press [入/切] to turn the power on.

The calibration screen for the handwriting pad appears.

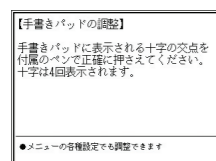

Main display

Handwriting pad

- If the power cannot be turned on:
 - Make sure the battery replacement switch is in the “ロック (使用時)” position, then press [入/切] again.
 - If the power still cannot be switched on, try performing steps 1 through 6 in the above procedure again.

7 Pull out the stylus, extend it, and use it to accurately touch the center of the “+” character displayed on the handwriting pad.

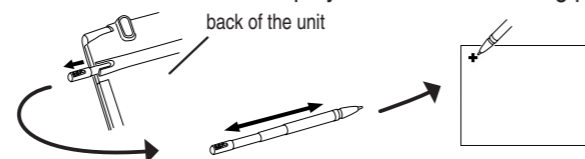

- Touch the center of “+” as it appears in four different locations. The LCD contrast adjustment screen appears.

8 Adjust the LCD contrast of the main display using [淡く] (←) and [濃く] (→).

9 The LCD contrast of the handwriting pad can be adjusted by touching [淡く] and [濃く] displayed on the pad.

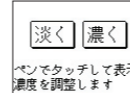

10 When done, press [検索/決定]. The key sound (beep) on/off screen appears.

11 Select [Y] or [N] to turn the key sound on/off. Kana input screen appears.

12 Press [Y] to select alphabet character input or press [N] to select Japanese input.

5 Likewise, enter “つ” in the entry area.

When you start drawing, the previous entry is confirmed then erased.



Entering characters using the dual-frame pad

Example: Enter “案山子 (かかし)” in スーパー大辞林.

1 Press [メニュー] [0] [0] [1].

2 Press [枠数切替] to switch to the dual-frame pad.



3 Use the stylus to draw “案” on the thick-framed (undotted) writing area.



Upon completion of each entry, the positions of these two areas switch automatically. The dotted-framed side cannot accept entries.

- To have the dictionary recognize the entry immediately, touch [確認] on the pad.

4 If a character is recognized incorrectly, use the stylus to touch the character. In the candidate display area, find and touch the character to replace it with.

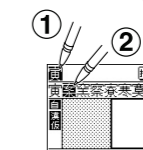

The character in the entry display area is replaced with the character selected in the candidate display.

5 Likewise, repeat the above steps 3 – 4 to enter “山” and “子”.

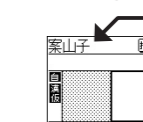

Up to 6 characters can be accommodated.

For longer words, enter up to six characters, then touch [採用] to transfer the entries to the content's entry field.

6 When done entering, touch [採用] to transfer the characters to the content's entry field.

You can then proceed with the dictionary search.

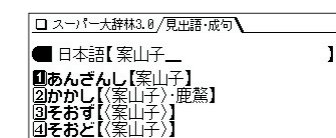

Selecting a dictionary/function in the menu display

Press **[メニュー]**.

The menu display (dictionaries/functions selection display) appears.

The menu display (dictionaries/functions selection display)

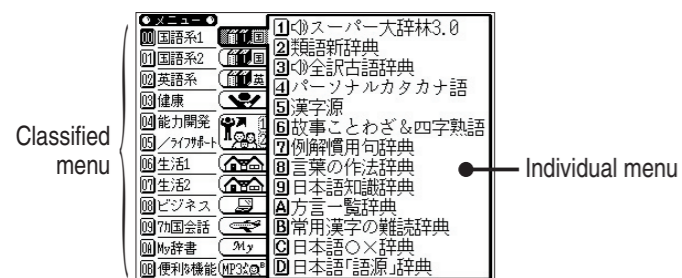

Menu operation

The menu display consists of a list of classified menu items each with a two digit alphanumeric character (00 - 99) to the left.

When you press **[メニュー]** to open the menu display, “00 国語系1 (Japanese dictionary)” is selected and the color of the number is inverted (black and white reversed).

Press **[上]** or **[下]** to move the cursor (indicated by the color-inverted number) and choose a different dictionary/function.

Individual menu items of each classified menu are displayed on the right.

Selecting a menu item

• Select using the cursor keys and **[検索/決定]**

1 Move the cursor (color-inverted) using **[上]** or **[下]** to the classified menu you wish to choose and press **[検索/決定]** or **[右]**.

• To return the cursor to the classified menu, press **[左]**.

2 Move the cursor using **[上]** or **[下]** to the dictionary/function you wish to use and press **[検索/決定]**.

The display of the dictionary/function you chose appears.

• Select using alphanumeric keys

1 Press the keys **[00]**, **[01]**, **[02]** to **[99]** that correspond to the number shown to the left of the classified menu (**00**, **01**, **02** to **99**) you wish to choose.

The cursor will be displayed on the individual menu of the classified menu you chose.

2 Press the alphanumeric key that corresponds to the characters shown to the left of the dictionary/function you wish to use.

The display of the dictionary/function you chose appears.

• When the cursor is on an individual menu, return the cursor to the classified menu by pressing **[戻る]** or **[左]**.

Using the ◀ mark on the display

Appearance of the marks **◀例**, **◀解説**, **◀NOTE**, **◀図** or similar on the detailed display indicates more information related to the entry is available, such as example sentences, explanations, notes, illustrations or diagrams.

Press **[例/解説]** to select the first mark and the color of the mark is inverted.

Press **[上]**, **[下]**, **[右]**, **[左]** to move the highlight to the desired mark and press **[検索/決定]** to display the contents.

To exit, press **[戻る]** twice.

When the **◀** mark appears, audio of the displayed information can be played back.

Press **[音声]** to select the first mark and the color of the mark is inverted.

Press **[上]**, **[下]**, **[右]**, **[左]** to move the highlight to the desired mark and press **[検索/決定]** to play back the contents.

Example: Play back the audio using “旅行会話 英語.”

1 Press **[メニュー]** **[09]** **[1]** and then press **[1]** **[4]** **[3]** to select the desired item.

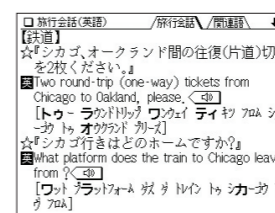

• Press **[音声]** and the mark becomes inverted (**◀**). Each time you press **[検索/決定]**, the audio plays.

If several **◀** marks appear in the display, press the **[上]** or **[下]** keys to move the cursor to the desired mark and press **[検索/決定]**. The word is inverted and its sound played using Text-to-Speech (TTS: synthesized voice).

◆ Press **[戻る]** to stop the audio during play. Press **[戻る]** and the color of **◀** reverts to non-inverted.

◆ Be sure to adjust the playback volume control at the left side of the unit to around the medium position before playing a sound and then adjust to an appropriate level.

Adjusting the playback speed

1 Press **[メニュー]** **[0B]** **[A]** **[7]**.

The playback speed setting display appears.

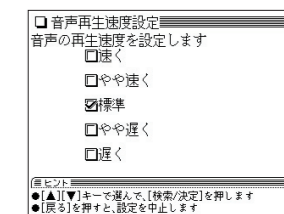

2 Press **[上]** or **[下]** to move the “✓” mark to select the playback speed (the default is “標準”) and then press **[検索/決定]**. The playback speed is set and the main menu display appears.

Playback speed can also be adjusted by pressing **[切替]** (再生速度) when the audio mark or a word is inverted.

Global search function

You can search for a word in several target dictionaries.

Input the Japanese or English spelling and find a definition from the target dictionaries.

As you type, candidates for matching narrow (filter search). If there are still many candidates after inputting the whole word, you can switch to exact search to browse only the exact word you wish to have defined.

Example: Global search for the word “advantage.”

1 Press **[一括検索]**.

The global search input display appears.

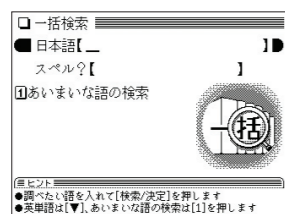

2 Press **[下]**.

Input “advantage” in “スペル?”.

As you type, candidates for matching narrow.



3 Press **[切替]** to search by exact search.

The list of words corresponding to your input appears.

If you wish to modify the entry, press **[切替]** to return to the filter search display and input again.

4 Select the desired word using the number keys.

The detailed display of the word appears along with its definitions.

• To return to the previous display, press **[戻る]**.



Preview display function

If many candidates are listed for a word and it is difficult to decide which word is the correct one, the preview display will help you by providing a brief note about each word.

Each time you press **[機能]** **[プレビュー]** (**早見**), the preview display is turned on or off.

(The preview display is turned off in this display example.)



S-jump function

You can search through the contents for the definition or meaning of a word on the detailed display.

Example: Use S-jump from the dictionary ジーニアス和英辞典 display.

1 Press **[メニュー]** **[02]** **[1]** and input “あいさつ/aisatsu” and then press **[検索/決定]**.

The display of “あいさつ” in the dictionary ジーニアス和英辞典 appears.

2 Press **[Sジャンプ]**.

Operation guide message of S-jump function.

• The cursor (color-inverted) appears.

3 Move the cursor (color-inverted) using **[上]**, **[下]**, **[右]**, **[左]** to the desired word.

• English words or the word indicated by the jump mark (▶) are selected in whole and their color inverted. You can also select an English word or the word indicated by the jump mark using **[Sジャンプ]** and skip the Japanese.

• To select a Japanese word, you must first mark the start and end points.

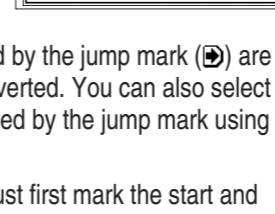
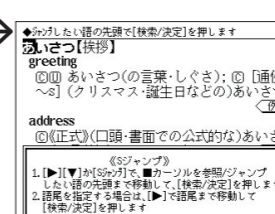
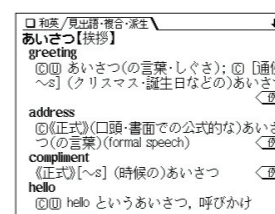

To mark the word “言葉”

Move the cursor “■” to the starting point “言” and press **[検索/決定]**. Then press **[右]** to move the cursor “■” to the end point “葉.” (If you wish to mark a one letter word, you do not have to mark the end point.)

4 Press **[検索/決定]**.

A list of candidates appears in the jump window.

• If the word is indicated with **▶** or there is only one match, the detailed display appears in the jump window.

5 Press the number key that corresponds to the desired word (in this case **[2]**).

The detailed display appears in the jump window.

6 Press **[検索/決定]** to S-jump the display.

The detailed display of the selected word appears.

• To return to the previous display, press **[戻る]**.

