

Layout

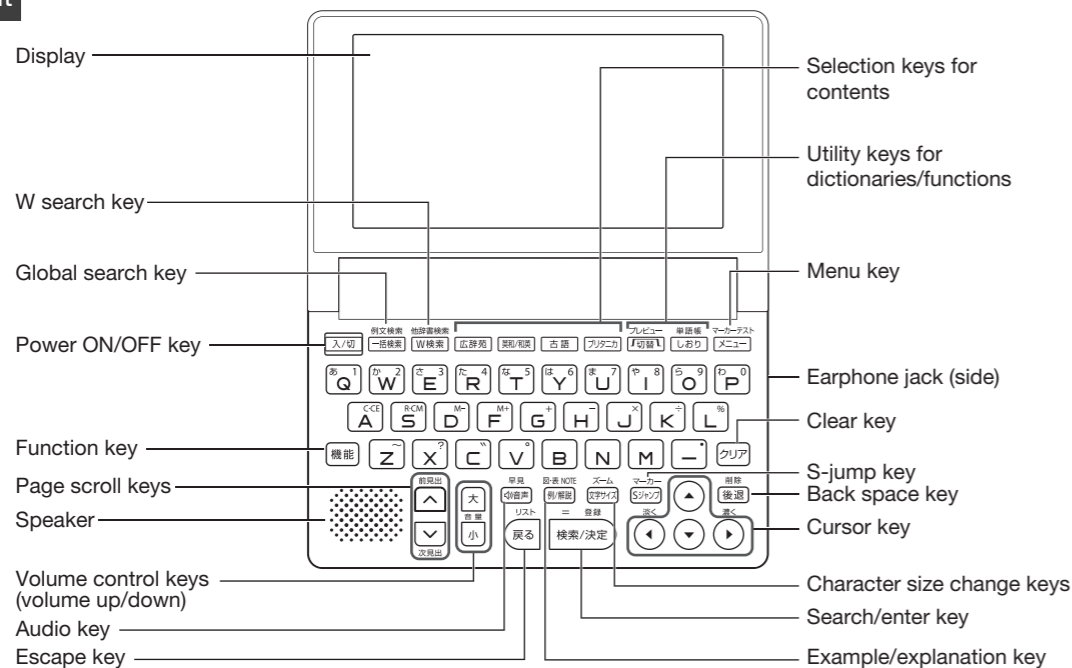

PRINTED IN JAPAN

09MSP

Selecting a content in the menu display

Press **メニュー**. The menu display appears.

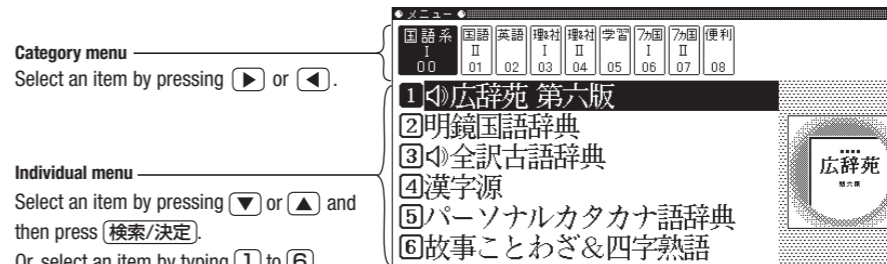

Category menu
Select an item by pressing **▶** or **◀**.

Individual menu
Select an item by pressing **▼** or **▲** and then press **検索/決定**.
Or, select an item by typing **1** to **6**.

Menu display
(contents/functions selection display)

Selecting a menu item

- 1 Press **メニュー**.
- 2 Use **▶** or **◀** to select a category menu item.
Or, use the numeric keys to enter the category number to select the item.
The individual menu for the selected category menu item appears.
- 3 In the individual menu, use **▼** or **▲** to select the content/function and then press **検索/決定**.
Or, use the numeric keys (**1** to **6**) to enter the number in front of the content/function (**1** to **6**).
The selected content/function screen appears.

Using the PW-GM510 for the first time

Insert the supplied batteries before using the PW-GM510.

- 1 Set the battery replacement switch on the bottom of the unit to the “解除” position.

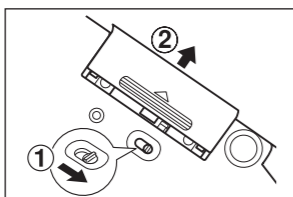

- 2 Remove the battery cover by sliding it in the direction indicated by the arrow.

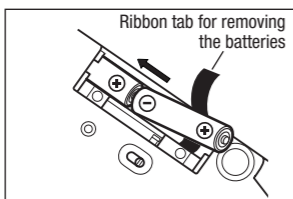

- 3 Make sure the battery polarity is correct.
 - Insert the batteries over the ribbon tab, being sure not to cover the end of the tab.

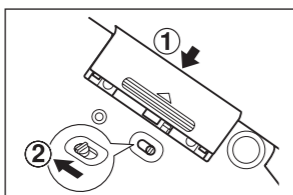

- 4 Insert the battery cover horizontally to put it back in place and set the battery replacement switch to the “ロック” position.

- 5 Open the unit and press **入/切** to turn on the power.

The LCD contrast adjustment screen appears.

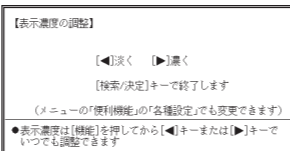

- 6 Adjust the contrast of the display by pressing **◀** (淡く) or **▶** (濃く).

- 7 After these adjustments, press **検索/決定**.
The key sound (beep) on/off screen appears.

- 8 Press **Y** or **N** to turn the key sound on/off.
The kana entry screen appears.

- 9 Press **Y** to select alphabet character input or press **N** to select Japanese input.
The battery type selection screen appears.

- 10 Select the battery type (“アルカリ乾電池 (alkaline dry cell)”) using **▼** or **▲** and then press **検索/決定**.
The menu display appears.

Global search function

You can search for a word in multiple contents/dictionaries.

Enter a word into the “読み” (Japanese reading) or “spelling” fields to search within the target dictionary.

As you type, the candidates for matching narrow (filter search). If there are still many candidates after entering the whole word, you can switch to “exact search” to browse only the exact word you wish to have defined.

Example: Global search for the word “advantage.”

- 1 Press **一括検索**.

The global search entry screen appears.
Select the text field according the entry character type by using **▼** or **▲**.

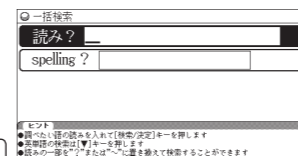

- 2 Press **▼** and enter “advantage” in the “spelling” field.

As you type, the candidates for matching narrow.



- 3 Press **切替** to search for words that match your entry exactly.

The list of words corresponding to your entry appears.



To change the entry, press **切替** to return to the filter search screen and enter again.

- 4 Select the desired word using **▼** or **▲** and press **検索/決定**.

The details screen of the word appears along with its definitions.

- To return to the previous screen, press **戻る**.

Preview display function

If many candidates are listed for a word and it is difficult to decide which word is the correct one, the preview display will help you by providing a brief note about each word.

Each time you press **機能切替** “プレビュー” (preview) while candidates are listed, the preview display will be shown on the right, turned off, or shown on the bottom in this order.
(The preview display is turned off in this screen example.)



Listening to audio

When the mark appears, audio of the displayed information can be played back.

Press to select the first mark, and the color of the mark is inverted.

Press , , , or to move the highlight to the desired mark and press to play back the audio.

Example: Play back the audio using “旅行会話 英語”.

1 Press , select “7 カ国会話 I” using , and confirm that “旅行会話 英語” is selected.

Press until the details screen is displayed.

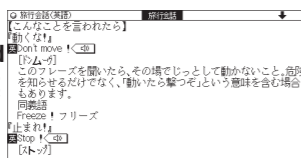

2 Press and the mark becomes inverted ().

Each time you press , the audio plays.

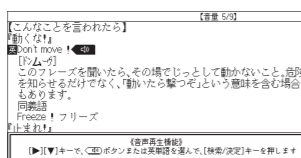

If several marks appear, press or to move the cursor to the desired mark and press .

By highlighting an English word and pressing , you can play back the audio for words that have audio entries in the English-Japanese dictionary.

◆ Press to stop the audio during play. Press and the color of reverts to non-inverted.

◆ Use or to first set the volume to low, then adjust it to the desired level.

Using the mark on the screen

Appearance of the , , , , or mark on the details screen indicates that more information related to the entry is available, such as example sentences, explanations, notes, illustrations, diagrams, and tables.

By pressing in screens where any of the above marks are displayed, the mark will become inverted.

When there are multiple marks, select the desired mark by using , , , or . By pressing , the contents are displayed. To exit, press twice.

S-jump function

You can search through the contents for the definition or meaning of a word on the details screen.

Example: Use S-jump from the ジーニアス和英辞典 screen.

1 Press .

The entry/selection screen for ジーニアス英和&和英辞典 appears.

2 Select the “読み” (Japanese reading) area using , enter “あいさつ”, and then press .

The “あいさつ” screen of the Japanese-English dictionary appears.

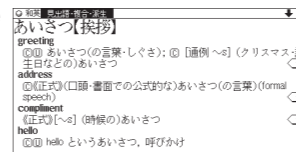

3 Press .

The cursor appears.

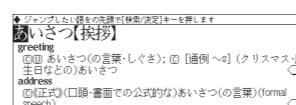

4 Move the cursor using , , , or to the desired word.

- English words or the word indicated by the jump mark () are selected in whole. Each time you press , you can jump to an English word, skipping Japanese.
- To select a word in kanji, hiragana, or katakana, you must first mark the start and end points.

Example: Marking the word “言葉”

Move the cursor “■” to the starting point “言” and press .

Then press to move the cursor “■” to the end point “葉”. (If you wish to mark a one letter word, you do not have to mark the end point.)

5 Press .

A list of candidates appears in the jump window.

- If the word is indicated with or there is only one match, the details screen appears in the jump window.

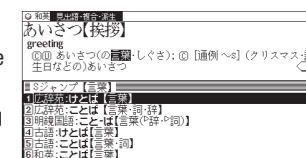

6 Select the desired word and then press .

The details screen appears in the jump window.

7 Press to jump the screen.

The details screen of the selected word appears.

- To return to the previous screen, press .

When multiple tabs appear at the top of the screen

Tabs indicate information related to the currently displayed entry.

Multiple tabs indicate that related information is available. You can view this information by pressing to switch the screen.

For example, by pressing and then pressing twice, you can display the English-Japanese dictionary details screen.

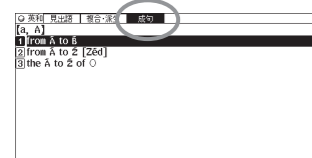
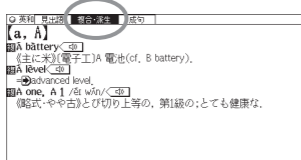
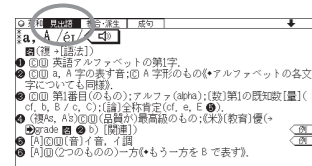

Search function for other dictionaries

The entry that appears in the details screen can be referenced in other dictionaries excluding the “天声人語”, “音声付き英語発音解説”, “現代社会テーマ集・日本国憲法”, “百人一首”, “現代文名作選”, “古典名作冒頭選”, “数学公式集”, and “トラベル英会話” dictionaries.

When the details screen appears, press and (他辞書検索). The search will begin. If there are any candidates, a new screen appears, and the contents are displayed.

- If there is only one match, the details screen appears in the window.

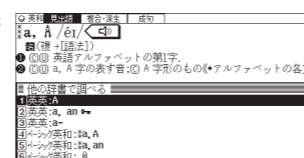

Select a candidate using or and then press to display the details screen.

Example sentence search function

It is possible to search for example sentences containing a word by entering it in the appropriate entry area.

Enter the word you would like to search for in the “spelling” or “読み” (Japanese reading) fields.

You can enter up to three words at one time.

Example: Search for the words “have” and “your”.

1 Press and (例文検索).

The entry screen appears.

2 Enter “have”, press and then enter “your”.

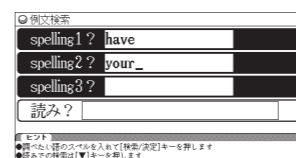

3 Press .

A list of example sentences for the entry appears.

- The tabs at the top of the display indicate the contents that include the example sentences found for the entry.

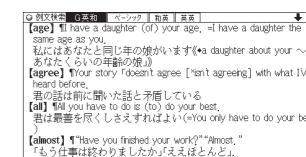

4 Press to select a content tab.



5 View the example sentences by using or .